

# Baoli ES 16-N02

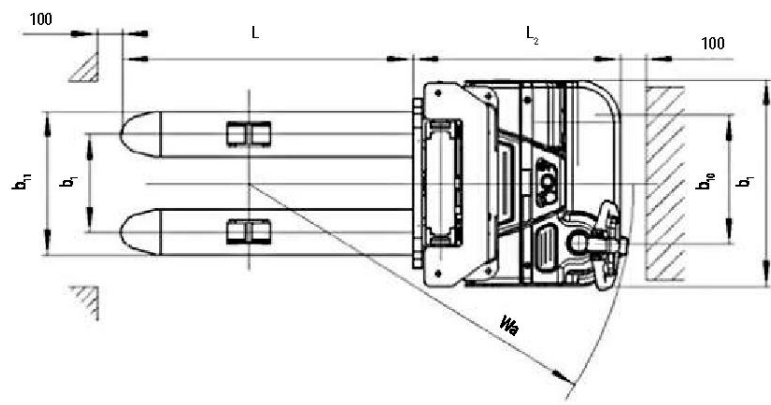

Baoli

|        |   |            |                 |
|--------|---|------------|-----------------|
| 1.1    | Manufacturer  |            | KION BAOLI      |
| 1.2    | Manufacturer's type designation                                 |            | ES 16-N02       |
| 1.3    | Drive: electric, diesel, petrol, fuel gas                       |            | Electric        |
| 1.4    | Operator type: hand, pedestrian, standing, seated, order-picker |            | Pedestrian      |
| 1.5    | Rated capacity / Rated load                                     | Q (t)      | 1.6             |
| 1.6    | Load centre distance  | c (mm)     | 600             |
| 1.8    | Load distance, centre of drive axle to fork                     | x (mm)     | 647             |
| 1.9    | Wheelbase   | y (mm)     | 1293            |
| 2.1    | Service weight  | Kg         | 1340            |
| 2.2    | Axle loading, laden front/rear                                  | Kg         | 930/2010        |
| 2.3    | Axle loading, unladen front/rear                                | Kg         | 850/490         |
| 3.1    | Tyres: solid rubber, superelastic, pneumatic, polyurethane      |            | PU              |
| 3.2    | Tyre size, front  |            | Ø 230x70        |
| 3.3    | Tyre size, rear   |            | Ø 85x75         |
| 3.4    | Additional wheels (dimensions)                                  |            | Ø150x54         |
| 3.5    | Wheels, number front/rear (x = driven wheels)                   |            | 1x+1/4          |
| 3.6    | Tread, front  | b10 (mm)   | 522             |
| 3.7    | Tread, rear   | b11 (mm)   | 390/505         |
| 4.2    | Height, mast lowered  | h1 (mm)    | 2108            |
| 4.3    | Free lift   | h2 (mm)    | 1520            |
| 4.4    | Lift  | h3 (mm)    | 4530            |
| 4.5    | Height, mast extended   | h4 (mm)    | 5088            |
| 4.9    | Height drawbar in driving position min/max                      | h14 (mm)   | 850/1385        |
| 4.15   | Height, lowered   | h13 (mm)   | 90              |
| 4.19   | Overall length  | l1 (mm)    | 1964            |
| 4.20   | Length to face of forks   | l2 (mm)    | 814             |
| 4.21   | Overall width   | b1/b2 (mm) | 820             |
| 4.22   | Fork dimensions ISO 2331  | s/e/l (mm) | 60/180/1150     |
| 4.25   | Distance between fork-arms                                      | b5 (mm)    | 570/685         |
| 4.32   | Ground clearance, centre of wheelbase                           | m2 (mm)    | 28              |
| 4.34.1 | Aisle width for pallets 1000 x 1200 crossways                   | Ast (mm)   | 2406            |
| 4.34.2 | Aisle width for pallets 800 x 1200 lengthways                   | Ast (mm)   | 2329            |
| 4.35   | Turning radius  | Wa (mm)    | 1510            |
| 5.1    | Travel speed, laden/unladen                                     | km/h       | 5,7/6,0         |
| 5.2    | Lift speed, laden/unladen                                       | m/s        | 0,130/0,200     |
| 5.3    | Lowering speed, laden/unladen                                   | m/s        | 0,250/0,170     |
| 5.8    | Max gradeability, laden/unladen                                 | %          | 6/12            |
| 5.10   | Service brake   |            | Electromagnetic |
| 6.1    | Drive motor rating S2 60 min                                    | kW         | 1.3             |
| 6.2    | Lift motor rating at S3 15%                                     | kW         | 3.2             |
| 6.3    | Battery according to DIN 43531/35/36 A, B, C, no                |            | 3VBS            |
| 6.4    | Battery voltage/nominal capacity K5                             | V/Ah       | 24/270          |
| 6.5    | Battery weight  | kg         | 230             |
| 6.6    | Energy consumption according to VDI cycle                       | kWh/h      | 1.59            |
| 8.1    | Type of drive unit  |            | AC              |
| 10.7   | Sound pressure level at driver's seat                           | dB (A)     | <70             |

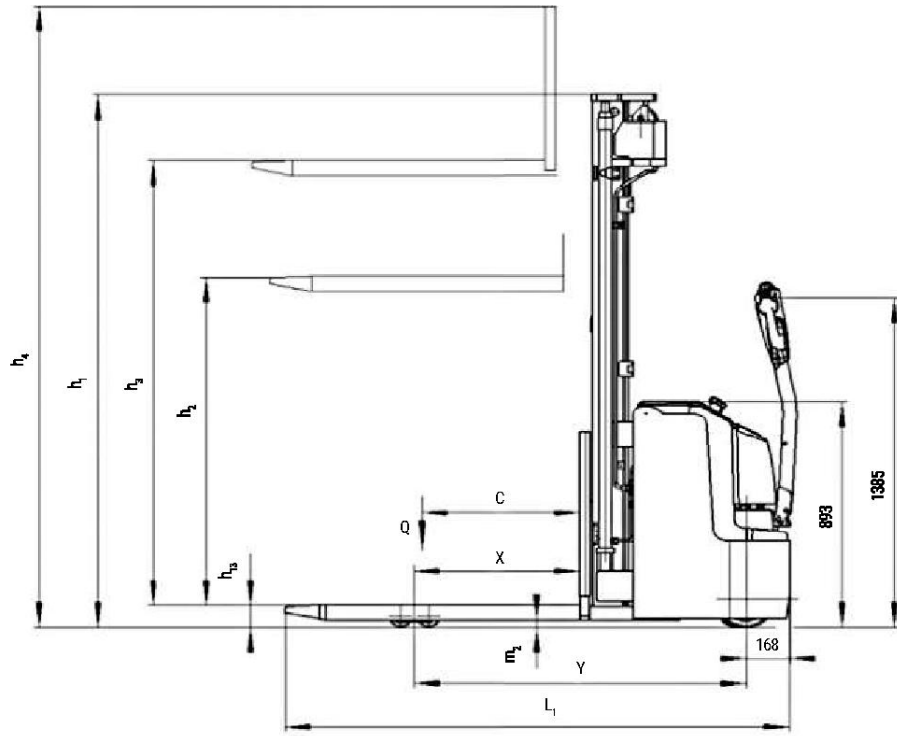

**ES 16-N02**

| Mast     | 2 stages<br>2900mm | 2 stages<br>3200mm | 2 stages<br>3600mm | 2 stages<br>with free lift<br>2900mm | 2 stages<br>with free lift<br>3200mm | 2 stages<br>with free lift<br>3600mm | 3 stages<br>4300mm | 3 stages<br>4600mm | 3 stages<br>with free lift<br>4300mm | 3 stages<br>with free lift<br>4600mm |
|----------|--------------------|--------------------|--------------------|--------------------------------------|--------------------------------------|--------------------------------------|--------------------|--------------------|--------------------------------------|--------------------------------------|
| H1       | 1958               | 2108               | 2308               | 1958                                 | 2108                                 | 2308                                 | 2008               | 2108               | 2008                                 | 2108                                 |
| H2       | -                  | -                  | -                  | 1410                                 | 1560                                 | 1760                                 | -                  | -                  | 1420                                 | 1520                                 |
| H3       | 2830               | 3130               | 3530               | 2830                                 | 3130                                 | 3530                                 | 4230               | 4530               | 4230                                 | 4530                                 |
| H4       | 3380               | 3680               | 4080               | 3380                                 | 3680                                 | 4080                                 | 4780               | 5080               | 4780                                 | 5080                                 |
| H3 + H13 | 2920               | 3220               | 3620               | 2920                                 | 3220                                 | 3620                                 | 4320               | 4620               | 4320                                 | 4620                                 |

| ES 16-N02 |        |
|-----------|--------|
| 2900 mm   |        |
| H3 (mm)   | Q (kg) |
|           |        |

| ES 16-N02 |        |  |
|-----------|--------|--|
| 3200 mm   |        |  |
| H3 (mm)   | Q (kg) |  |
|           |        |  |

| ES 16-N02 |        |  |
|-----------|--------|--|
| 3600 mm   |        |  |
| H3 (mm)   | Q (kg) |  |
|           |        |  |

| ES 16-N02 |        |  |
|-----------|--------|--|
| 4300 mm   |        |  |
| H3 (mm)   | Q (kg) |  |
|           |        |  |

|        |      |      |
|--------|------|------|
|        |      |      |
|        |      |      |
| 2900   | 1400 | 1100 |
| 2500   | 1600 | 1200 |
| c (mm) | 600  | 700  |

|        |      |      |
|--------|------|------|
|        |      |      |
|        |      |      |
| 3200   | 1200 | 900  |
| 2900   | 1400 | 1100 |
| 2500   | 1600 | 1200 |
| c (mm) | 600  | 700  |

|        |      |      |
|--------|------|------|
|        |      |      |
|        |      |      |
| 3600   | 1000 | 700  |
| 3200   | 1200 | 900  |
| 2900   | 1400 | 1100 |
| 2500   | 1600 | 1200 |
| c (mm) | 600  | 700  |

|        |      |      |
|--------|------|------|
|        |      |      |
|        |      |      |
| 4300   | 900  | 600  |
| 3600   | 1000 | 700  |
| 3200   | 1200 | 900  |
| 2900   | 1400 | 1100 |
| 2500   | 1600 | 1200 |
| c (mm) | 600  | 700  |

| ES 16-N02 |        |      |
|-----------|--------|------|
| 4600 mm   |        |      |
| H3 (mm)   | Q (kg) |      |
| 4600      | 800    | 500  |
| 4300      | 900    | 600  |
| 3600      | 1000   | 700  |
| 3200      | 1200   | 900  |
| 2900      | 1400   | 1100 |
| 2500      | 1600   | 1200 |
| c (mm)    | 600    | 700  |

## ES 12N03-16 N02



The Baoli ES 12-N03 and ES 16-N02 pallet stackers are perfect for the transport and storage of loads from 1200 to 1600 kg.

The ES 12-N03 features a 24 V / 180 Ah lead acid battery. The ES16-N02 is equipped with a higher capacity battery of 24 V / 270 Ah.

Thanks to the sensitive operation and proportional operating controls, these pallet stackers provide high handling efficiency.

The long tiller arm ensures optimal and highly ergonomic control of the vehicle. It requires less operating force and allows the driver to always keep an optimal distance from the vehicle.

Sturdy construction quality and high technological standards make the ES 12-N03 and ES 16-N02 pallet stackers a real benchmark in their sector. These pallet stackers impress with maximum efficiency and reduced maintenance costs.

### Technology and features

- ✓ AC technology
- ✓ High quality components
- ✓ Electronics protected against water and dirt
- ✓ Perfect driving modulation
- ✓ Robust four-support-points chassis
- ✓ Two and three stages masts available
- ✓ Up to 4600 mm lifting height
- ✓ Forks with an overall width of 570 or 685 mm available
- ✓ Low-mounted tiller for less manoeuvring effort
- ✓ Automatic lift slowdown at maximum height.

